



## MyLEDLightingGuide Retrofit Kit User Installation Manual

### WARNING:

- Risk of Fire / Electric Shock - Installation must be done by a qualified electrician.
- For your safety read and understand instructions completely before starting installation.
- For a list of all retrofit kits, visit <http://www.myledlightingguide.com/led-retrofit-kits>

### Important steps that should be followed before installing LED retrofit kits:

1. Make certain power is OFF before starting installation. Remove bulb and existing ballast or cut the wires to the ballast and bypass it.
2. For Longest Life & to keep the LED Head & Driver cool - PERMANENTLY REMOVE THE FIXTURE'S REFLECTOR. RETROFIT WARRANTY IS VOID IF THE FIXTURE'S REFLECTOR IS NOT REMOVED.
3. Wipe excess dust from inside the fixture. Clean the fixture's glass if dirty.

The LED retrofit kits can be either mounted by "L bracket", or by "Flat plate", both are provided.

### Installation option: Mounting by "L bracket":

1. Mount the pre-assembled bracket (see FIG.1) to fixture (see FIG.2 for an example).



FIG.1



FIG.2

2. There is a mounting port on the top of the LED head. Insert the port to the bracket, and then attach the metal cord (already with one end attached to the bracket) to the LED head, by fixing it to a screw hole on the side of the LED head, using a butterfly screw (provided).

**Adjust the length of the metal cord and make sure it's tight, such that the LED head is firmly locked with the bracket.** The butterfly screw can be used without tool (see FIG 3).



# MY LED LIGHTING GUIDE

YOUR GUIDE TO ENERGY EFFICIENT LED LIGHTING

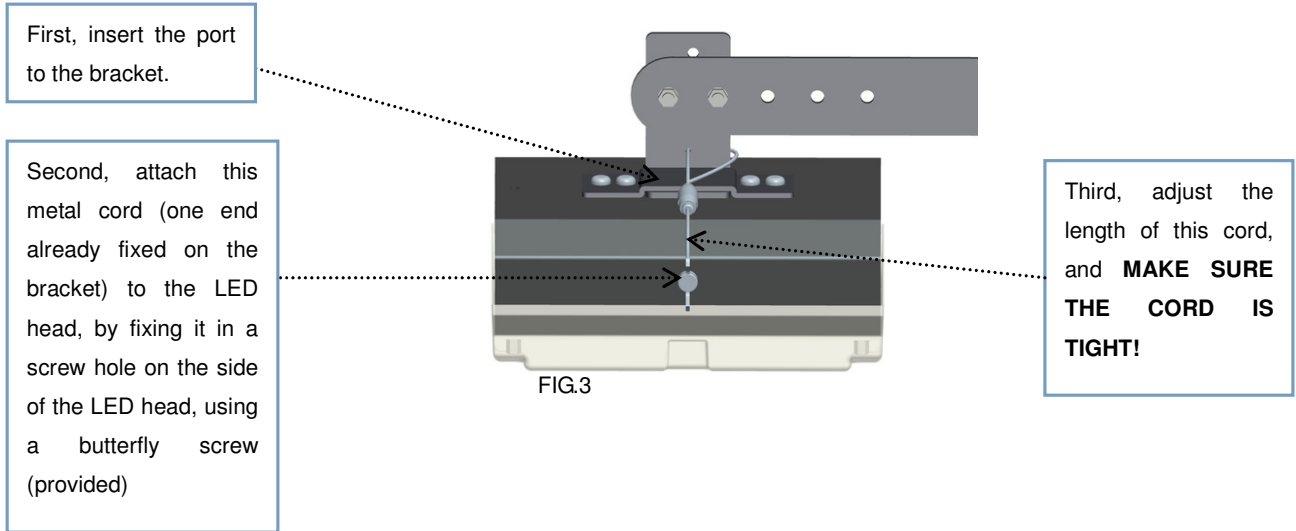

3. Secure the metal cord(s) (already with one end attached the LED head, see FIG. 4) to the fixture, such that the head will not get inclined.

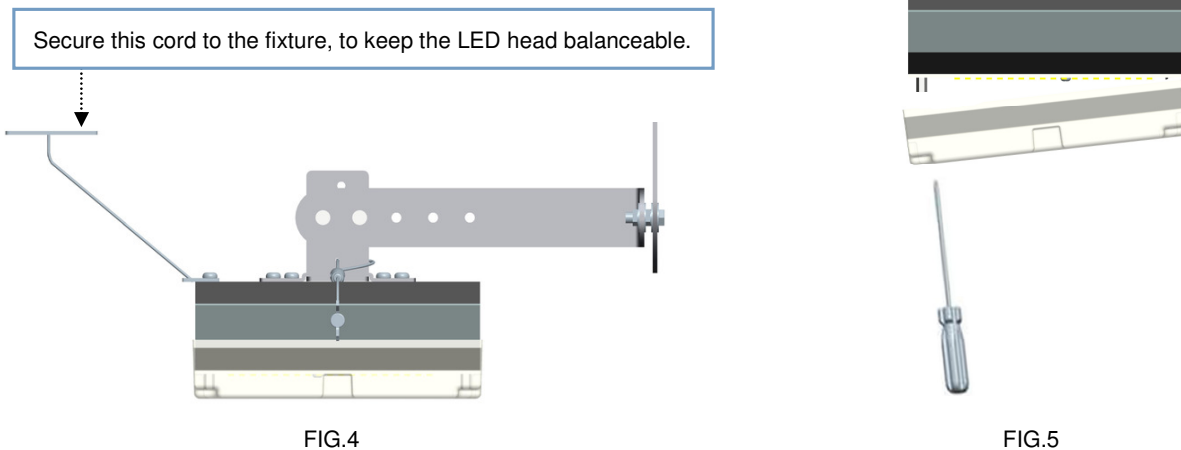

(This step should be done for LED retrofit kits 75W to 350W.)

4. Remove the PC protective cover on the LED head (see FIG. 5). The PC cover is only meant to protect the LEDs during shipment and installation. It has to be removed after installation. Do not touch the LEDs, it will damage them and cause premature failure.

5. BE SURE THAT NOTHING WILL TOUCH OR FALL INTO THE FAN BLADES AFTER THE FIXTURE IS MOUNTED.



## Installation option: Mounting by “Flat mounting plate”

(This option is mostly used as a vertical mounting way):

1. To use this option, replace the pre-assembled “L bracket” with a “flat plate” (See FIG.6, FIG.7, FIG.8)

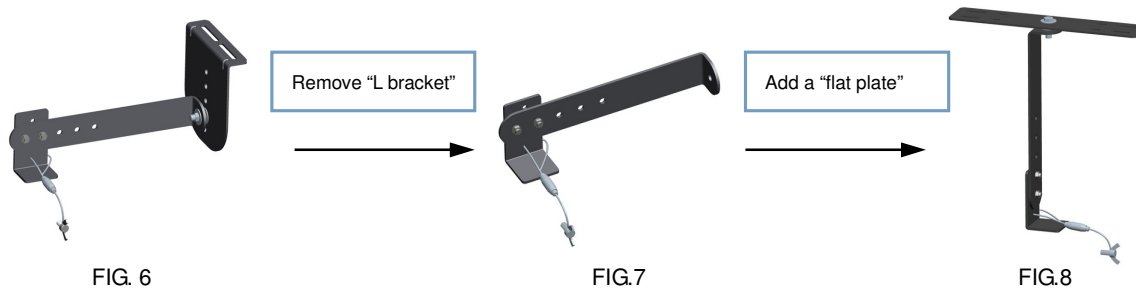

2. Mount the bracket with flat plate to fixture (See FIG.9 for an example).

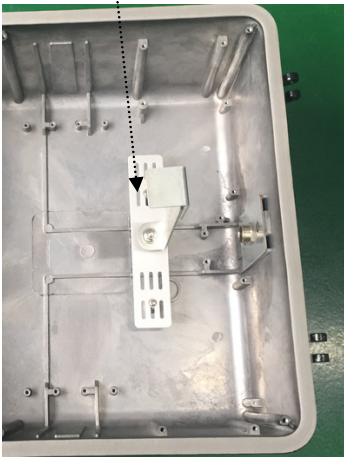

FIG.9

3. There is a mounting port on the top of the LED head. Insert the port to the bracket, and then attach the metal cord (already with one end attached to the bracket) to the LED head, by fixing it to a screw hole on the side of the LED head, using a butterfly screw (provided).

**Adjust the length of the metal cord and make sure it's tight, such that the LED head is firmly locked with the bracket.** The butterfly screw can be used without tool (see FIG 10).



## MY LED LIGHTING GUIDE

YOUR GUIDE TO ENERGY EFFICIENT LED LIGHTING

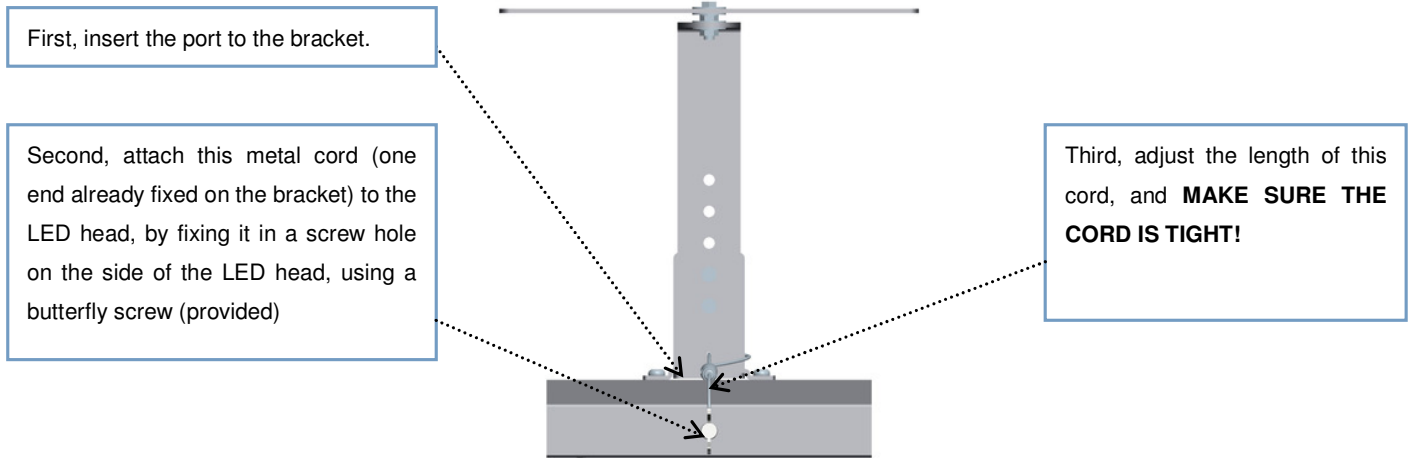

FIG. 10

4. Secure the metal cord(s) (already with one end attached the LED head, see FIG. 4) to the fixture, such that the head will not get inclined. (refer to FIG.4)
5. Remove the PC protective cover on the LED head (Refer to FIG. 5). The PC cover is only meant to protect the LEDs during shipment and installation. It has to be removed after installation. Do not touch the LEDs, it will damage them and cause premature failure.
5. BE SURE THAT NOTHING WILL TOUCH OR FALL INTO THE FAN BLADES AFTER THE FIXTURE IS MOUNTED.

## Wiring

1. Install the LED driver in place of the ballast.
2. Wire the input source to the LED driver. The proper AC input connections to the driver are marked on the driver. There is a Ground, ACN (Neutral) and ACL (Line). **IMPORTANT**: MAKE SURE THE WIRING IS PROPERLY GROUNDED.
3. Connect the output wires of the driver to the input wires of the LED Head: **Make certain to connect the Red Wire of the driver output to Red Wire of the LED head, and connect the Black Wire of the driver output to the Black Wire of the LED head.**
4. Re-assemble remaining parts of the fixture and restore power.
5. Never dim a non-dimmable LED driver. Not intended for use with emergency exits.



# MY LED LIGHTING GUIDE

YOUR GUIDE TO ENERGY EFFICIENT LED LIGHTING

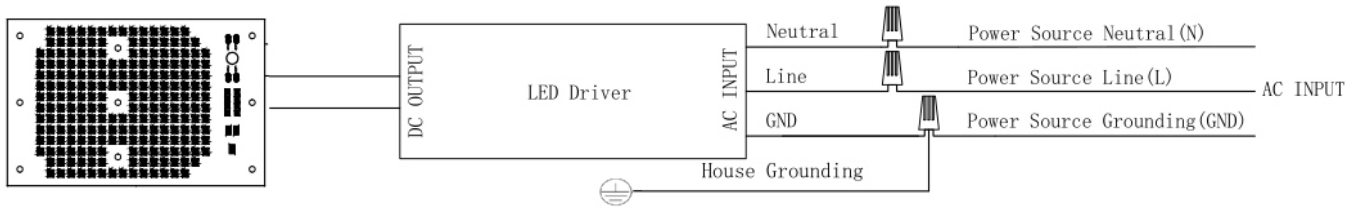

MODEL \_\_\_\_\_ WATTS \_\_\_\_\_

VOLTS \_\_\_\_\_ AMPS \_\_\_\_\_

RECOGNIZED  
COMPONENT



**Intertek**  
4010246

CONFORMS TO UL ANSI/UL  
STD 1598, UL SUB 1598C  
CERTIFIED TO CAN/CSA  
STD C22.2 NO. 250.0  
CSA Letter No. B-79

[www.MyLEDLightingGuide.com](http://www.MyLEDLightingGuide.com)

(888) 423.3191